

# Cover Sheet

Please complete this page ONCE and return with your  
Grant Category Application(s)

Town/Organization: Town of Westmore  
Primary Contact Person (Responsible for Signing Grant Agreement): David Stevens / Peter Hyslop  
Title: Chair / Board VICE-CHAIR  
BOARD  
Address: 30 Hin ton Hill RD Orleans VT 05860  
Street Address Town Zip

Primary Contact Person Email:  
Daniel Sica rd Phone: (802) 624 -  
6424

SAM unique ID #: CNMWAUQJUKJ4 Fiscal Year End  
Month (MM): 3/14/2024

Town Clerk / Admin email:  
Clerk@westmoreonline.org

Road Foreman Name: Daniel Sica rd Road  
Foreman Email: Westmore vt highway@gmail.com



## CATEGORY B/C/D

Please complete one application per project you are applying  
for.

Please check the Category you are applying for:

- B. Correction of a Road Related Erosion Problem and/or Stormwater Mitigation
- C. Correction of a Stream Bank, Lake Shore or Slope Related Problem
- D. Structure/culvert 36" diameter or greater

Municipality: Town of Westmore  
Road Name: Perkins Ln TH #: \_\_\_\_\_  
11 Structure # (if applicable): 732005000057

Road Type: Paved or Unpaved (select one) Road  
Class: 1 2 3 4 (select one)

Please provide a thorough description of the erosion/water quality problem (ex. Roadway has steep slope with no ditch which is causing severe roadway erosion, which outlets into the Lamoille River):

The Culvert needs to be upsized with stone header also the outlet has really bad erosion washing the bank out. The outlet erosion is putting this segment in high priority. The culvert also needs to be aligned with the stream flow to stop the washing of the bank. The lower culvert should be replaced id # 732005000057 with stone header on both inlet and outlet of the culvert. also pull berms off and add gravel

Has the town completed an MRGP compliant road erosion inventory?

Yes

No

In progress

Project Length (linear feet along roadway):

656 ft.

Number of structures/culverts replaced/repaired:

1

Average slope of roadway:

10% >10%

0-5%

5-

Provide a VERY detailed map of project location showing start and end points: Included

Provide a sketch of project location showing distances and project details: Included

Please provide the Road Segment ID (RSID) for your project. If several, please list all. In addition to the RSID please indicate what the resulting rating of each segment before construction as well as after construction in accordance with the MRGP.\* (i.e., Fully Meets Standard,



- Reestablishing existing ditches only
- The structure is being replaced on existing location/alignment
- Excavation within a floodplain – **Take pictures**
- Tree cutting/clearing – **Take pictures**
- existing road or shoulder
- There will be excavation within 300 feet of a river or stream – **Take pictures**
- Road reclaiming, reconstruction, or widening
- Temporary off-road access is required
- The roadway will be realigned

**Please describe the project and how it will create a positive water quality benefit (ex. Reshape 500' of ditch and line with 12 inch minus stone, to prevent sediment from entering the Lamoille River at the bottom of the hill):**

*We are going to upsize the 24 inch culvert to a 40 Foot 36 inch culvert and ~~align~~ line it up with the stream flow to stop the bank from washing out. we will put stone headers a long with stone in and around the wash out areas to stop all the erosion. we are going to stabilize the banks with 12 inch minus to prevent sediment from entering the stream.*

**Please list any professionals or partners that assisted with planning this project (ANR River Management Engineer, Army Corps of Engineers, VTrans staff, Basin Planner, RPC staff, etc.):**

---



---



---

**Is the project located in the town "Right of Way?" (select one)**  Yes  No  Both

Please be aware, Municipalities are required to have an Agreement for Entry & Liability Release for any impacted properties (prior to the start of construction.)

Budget:

**Please attach a project budget and confirm below that is attached:**

**Project budget IS attached**

**Are you applying to other grant programs to help fund this project? If so, what programs?** Please note that Better Roads requires a 20% local match and Better Roads funding may not be used as match for other state or federally funded programs.

	<b>Requested Grant</b>
<b>Amount Max:</b>	
	<b>Requested Grant Amount:</b> \$
	\$20,000 Category B
	+
Category C	\$40,000
	<b>Local Match:</b> \$ <u>4,000</u> .00
	\$60,000 Category D
	=
	<b>Total Project Cost:</b> \$ <u>19,377.30</u>

**Estimated Completion Date:** \_\_\_\_\_

**REQUIRED ATTACHMENTS:**

Please use the documentation checklist below to ensure that all of the relevant items regarding your application have been included. **It is preferred that your application is a single PDF file.**

- Grant application cover sheet
- Grant application form, including chart with RSID and MRGP compliance before and after project completion
- Itemized Cost estimate for labor, equipment, and materials (see enclosed Cost Estimate Worksheet). If applicable, please break down funding by source (i.e. different grant sources).
- Detailed Project Location Map
- Sketch of proposed project and erosion control measures or other management practices, including distances in feet
  - Also show approximate location of town/other right-of-way and/or property lines and limits of work
- Photos must be color and clear to see.
  - Please make sure there are enough photos to get a good idea of the project area
- Other appropriate supporting documents.

By signing this application, I certify that all the information provided is accurate to the best of my knowledge. We will comply with all the requirements of the grant including making our books available for audit if required.

**SIGNATURE OF APPLICANT:**

Name: \_\_\_\_\_



Title: Road Connection

**MUST BE TOWN ADMINISTRATOR/MANAGER OR  
SELECT BOARD CHAIR**

Vermont Better Roads Category C/D Grant Proposal Scoring  
Criteria

All applications will be scored on a sliding scale selected by the Better Roads Grant Selection Committee. Road BMP upgrades are considered the highest priority for grant funding when road segments are “hydrologically-connected,” currently “not meeting” MRGP standards, and road slopes are greater than 10%

**1. Is the project using Best Management Practices (BMPs) that are proven and likely to maximize long term success, such as practices contained within the new VTrans Better Roads Manual and/or VT DEC MRGP Standards??**

**[maximum 20 points]**

- The proposed project utilizes appropriate BMPs and has maximized the likelihood of long-term success (16-20 points)
- The proposed project utilizes some appropriate BMPs but more could be done to increase the likelihood of success (11-15 points)
- The proposed project does not utilize appropriate BMPs, or it is unclear whether the BMPs will be used appropriately and the likelihood of success is uncertain (0-10 points)

**2. What are the expected Water Quality Benefits within the watershed? [maximum 25 points]**

- Project will lead to significant improvements to water quality (21-25 points)
- Project will lead to moderate improvements to water quality (16-20 points)
- Project will lead to small improvements to water quality (1-15 points)
- Project will lead to no obvious improvements to water quality (0 points)

**3. Is the project in or does stormwater runoff from the project area drain into a hydrologically connected**

**segment? [maximum 20 points]**

- Yes; the entire project is in connected segment(s) (20 points)
- Partially; part(s) of the project are in connected segments (5-19 points)
- No; this project is not in a connected segment (0-5 points)

**4. Will the project result in full compliance of one or more segments in accordance with the Municipal Roads General Permit (MRGP)? [maximum 25 points]**

- All segments within the project will be in full compliance (25 points)
- One or more segments will be in full compliance, with all other segments in partial compliance (11 – 24 points)
- One or more segments will be a minimum of partial compliance (1- 10 points)

- Project does not meet compliance or not applicable (does not have hydrologically connected segments) (0 points)

**5. Is the project cost effective? [maximum 10 points]**

- The cost of the project is low and the expected benefits are high (8-10 points)
- The cost of the project is average and the expected benefits are average (5-7 points)
- The cost of the project is high and the expected benefits are low (0-4 points)

- 
- 
- 

Vermont Better Roads Grant Program

## **COST FOR GRANTS**

<u><b>Laborers</b></u>	<u><b>Rate/HR</b></u>	<u><b>Worked hrs</b></u>	<u><b>Total</b></u>	
Dan	30	45	1350	
Riley	25	43	1075	
Darcy	25	24	600	
		<b>TOTAL</b>	<b><u>3025</u></b>	3025
<u><b>Equipment</b></u>				
Excavator	85	20	1700	
6 wheeler	85	0	0	
10 wheeler	90	36	3240	
10 wheeler	90	40	3600	
Loader	75	2	150	
Tractor	55	0	0	
Grader	85	2	170	
		<b>TOTAL</b>	<b><u>8,860</u></b>	8860
<u><b>Culvert</b></u>				
	<u><b>Per Foot</b></u>	<u><b>Number of feet</b></u>		
Band 24	120	1	120	
24 inch	48.08	30ft	1442.4	
36 inch	50.21	40ft	2008.4	
Band 36	190	1	190	
		<b>TOTAL</b>	<b><u>3760.8</u></b>	3760.8
<u><b>Hydro Seed</b></u>				
Per foot	0.65	250ft	162.5	
		<b>TOTAL</b>	<b><u>162.5</u></b>	162.5
<u><b>Town clerk</b></u>				
	45	5	225	
		<b>TOTAL</b>	<b><u>225</u></b>	225
<u><b>GRAVEL</b></u>				
	<u><b>Per yard</b></u>	<u><b>TOTAL Yards</b></u>		
	13	176	2288	
		<b>TOTAL</b>	<b><u>2288</u></b>	2288
<u><b>Erosion Stone</b></u>				
	<u><b>Per Ton</b></u>	<u><b>Total Ton</b></u>		
-12 in	12	88	1056	
		<b>TOTAL</b>	<b><u>1056</u></b>	1056
		<b>TOTAL</b>	<b><u>19,377.30</u></b>	



Westmore, VT, USA

Show search results for Westmore, V...

Culvert and Bridge Filters

Culverts

Culvert Filters

Bridge Filters

**Culvert in WESTMORE**

Road name	PERKINS LN
Local id	732005000057
Location description	
Driveway or Drainage	Not Yet Determined
Culvert material	Steel Corrugated
Overall condition	Good
Header material	Unknown
Header condition	Unknown
Height (in.)	24
Width (in.)	24
Length (ft.)	26

Zoom to

60ft

72.047572 44.777393 Degrees

Bridges Culverts

Options Filter by map extent Zoom to Clear selection Refresh

Road name	Local ID	State bridge number	Location description	Bridge type	Bridge material	Feature crossed	Bridge spa
GREEN MOUNTAIN TPKE	B3	B3	Above new culvert	Stringer/Multi-Beam or Girder	Timber	Perennial stream	20
TOWN HWY 16	B8	B8		Unknown	Unknown		0

2470 features 0 selected

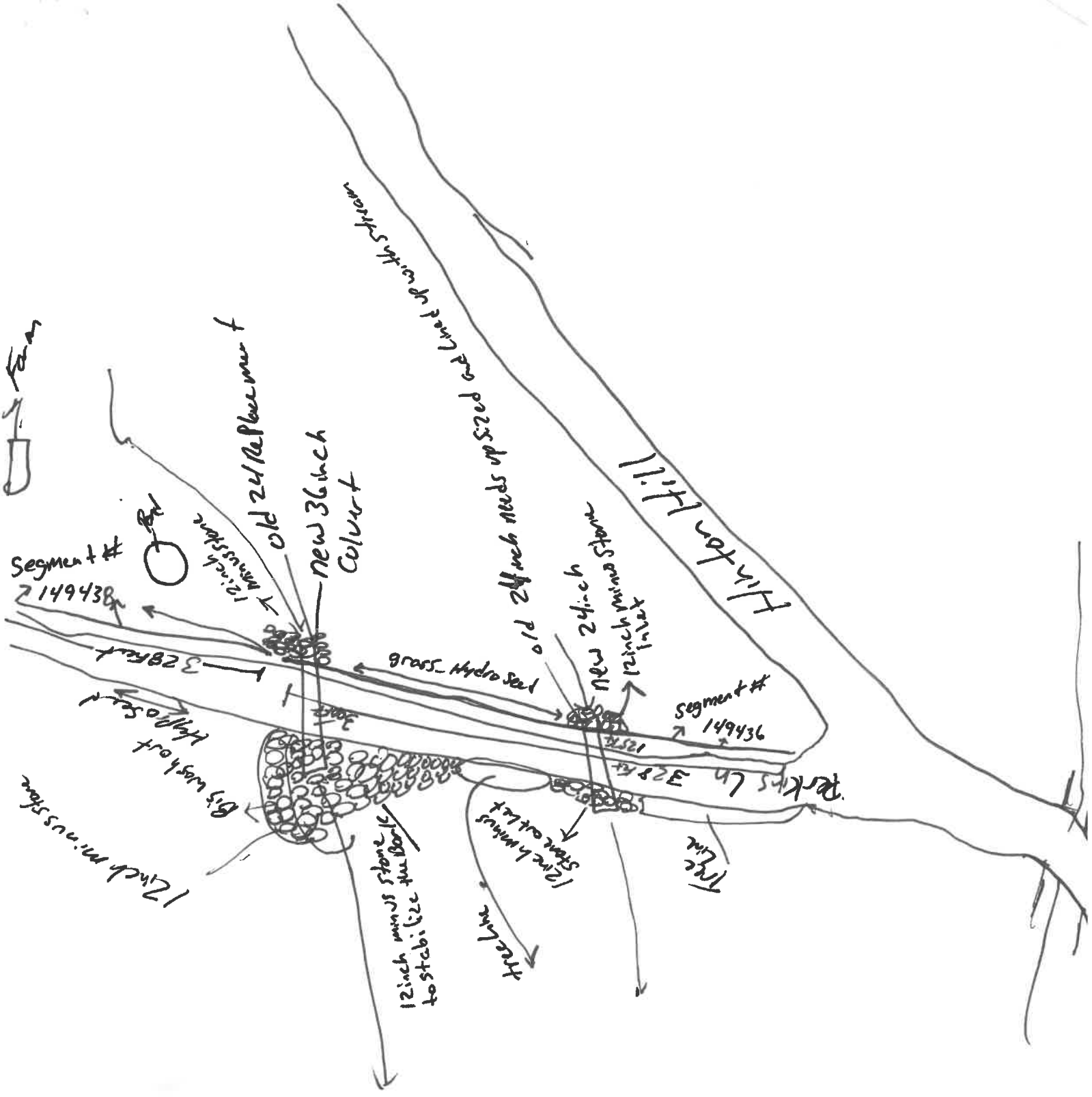

PERKINS LN

new 24 inch  
culvert

replace old 24 inch  
culvert with

PERKINS LN

new 36  
inch culvert

PERKINS LN

2-90 Perkins Ln

HINTON HILL RD

TON HILL RD

E

3D



Find address or place

ns Ln

Perkins Ln

Perkins Ln

Perkins Ln

New 36 inch  
40 foot Culvert

New 24 inch  
Culvert



 E  
 3D  
  

Westmore, VT, USA

Show search results for Westmore, V

Perkins Ln

Hinton Hill Rd

60ft

-72.047591 44.777389 Degrees

POWERED BY esri

Road name	PERKINS LN
Local id	732005000057
Location description	
Driveway or Drainage	Not Yet Determined
Culvert material	Steel Corrugated
Overall condition	Good
Header material	Unknown
Header condition	Unknown
Height (in )	24
Width (in )	24
Length (ft )	26
<a href="#">Zoom to</a>	...

Bridges Culverts

Options Filter by map extent Zoom to Clear selection Refresh

Road name	Local id	Location description	Driveway or Drainage	Culvert material	Overall condition	Header material	Header condition
WHITTIER HILL RD	230200497T		Not Yet Determined	Plastic Corrugated	Good	Unknown	Unknown
POPPLE DUNGEON RD	POPPLE DUNGEON RD-10		Drainage	Steel Corrugated	Fair	Stone masonry	Good

111534 features 0 selected





































